

SEPTEMBER 11, 1934
\$1,600

IN 2020 DOLLARS: \$30,533

**TSUNEMATSU MURAKAMI
BUYS A FARM ON
SALT SPRING ISLAND.**



KEY MAP





NOVEMBER 25, 1944
\$988

IN 2020 DOLLARS: \$14,918

**THE OFFICE OF THE
CUSTODIAN FORCES SALE.**

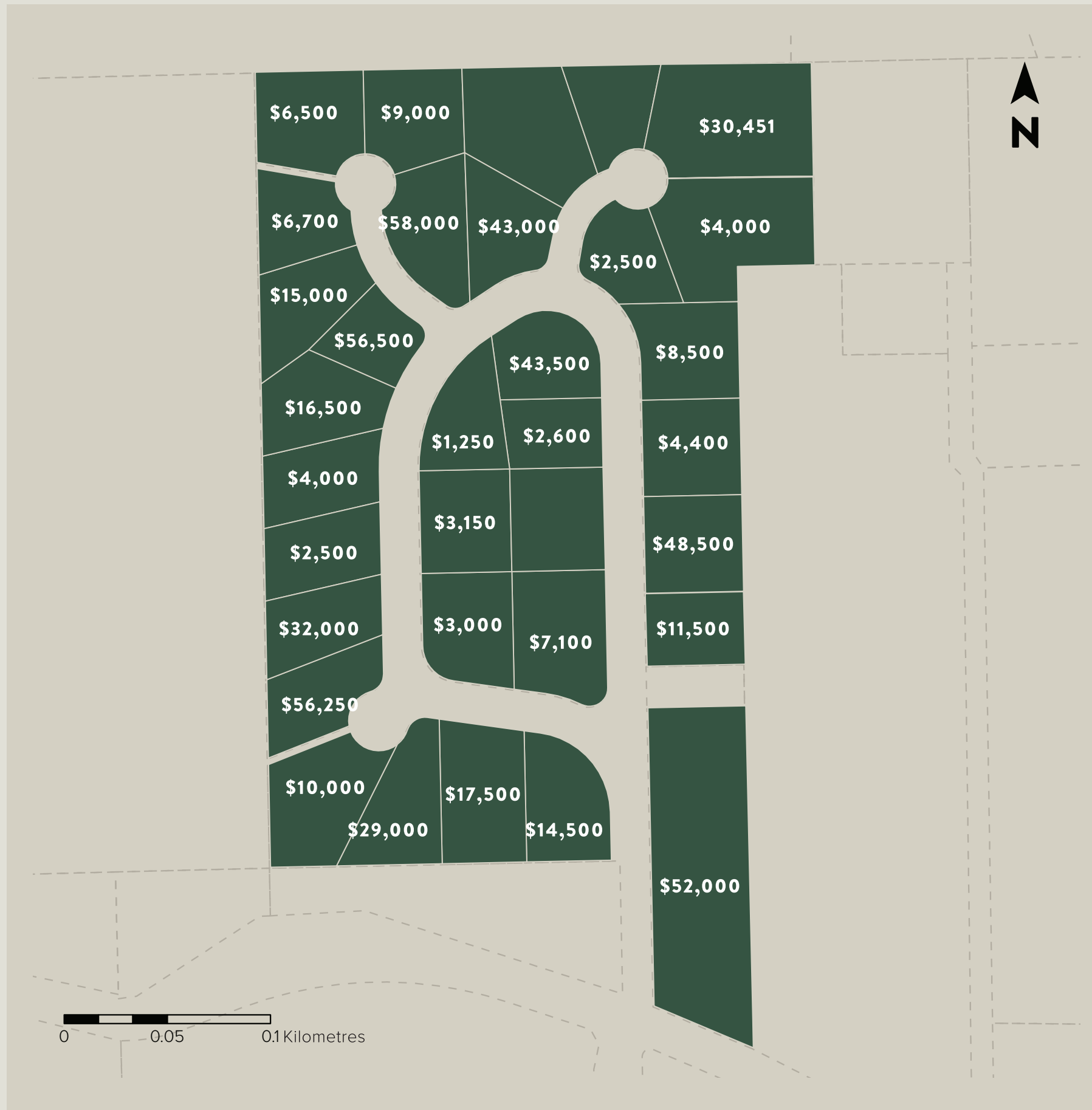

1965-1976

\$599,401

IN 2020 DOLLARS: \$3,197,683

A GENERATION LATER

By the 1970s, the Murakami farm had increased significantly in value. Its purchasers divided and sold it for profit.